

Diody pro všeobecné použití

objednávací název	I _f max(A)	U _r max(V)	pouzdro
F1A7	1	1000	R1
■ 1N 4007	1	1000	DO 41
1N 4007G	1	1000	DO 41
■ BY 133	1	1300	DO 15
EM 513	1	1300	DO 41
■ BY 228	1	1500	DO 15
EM 516	1	1600	DO 41
EM 518	1	2000	DO 41

Diody výkonové

	I _f max(A)	U _r max(V)	pouzdro
1N5399	1.5	1000	DO 15
RL 257	2.5	1000	DO 15
■ BY 251	3	200	DO 201
■ BY 255	3	1000	DO 201
■ 1N 5408	3	1000	DO 201
■ BY 550-100	5	100	P5
BY 550-600	5	600	P5
■ FR6A07	6	1000	R6
FR10A01	10	50	R6
FR10A02	10	100	R6
FR10A03	10	200	R6
FR10A04	10	400	R6
FR10A05	10	600	R6
FR10A06	10	800	R6
FR10A07	10	1000	R6
FR1606	16	800	TO 220AB

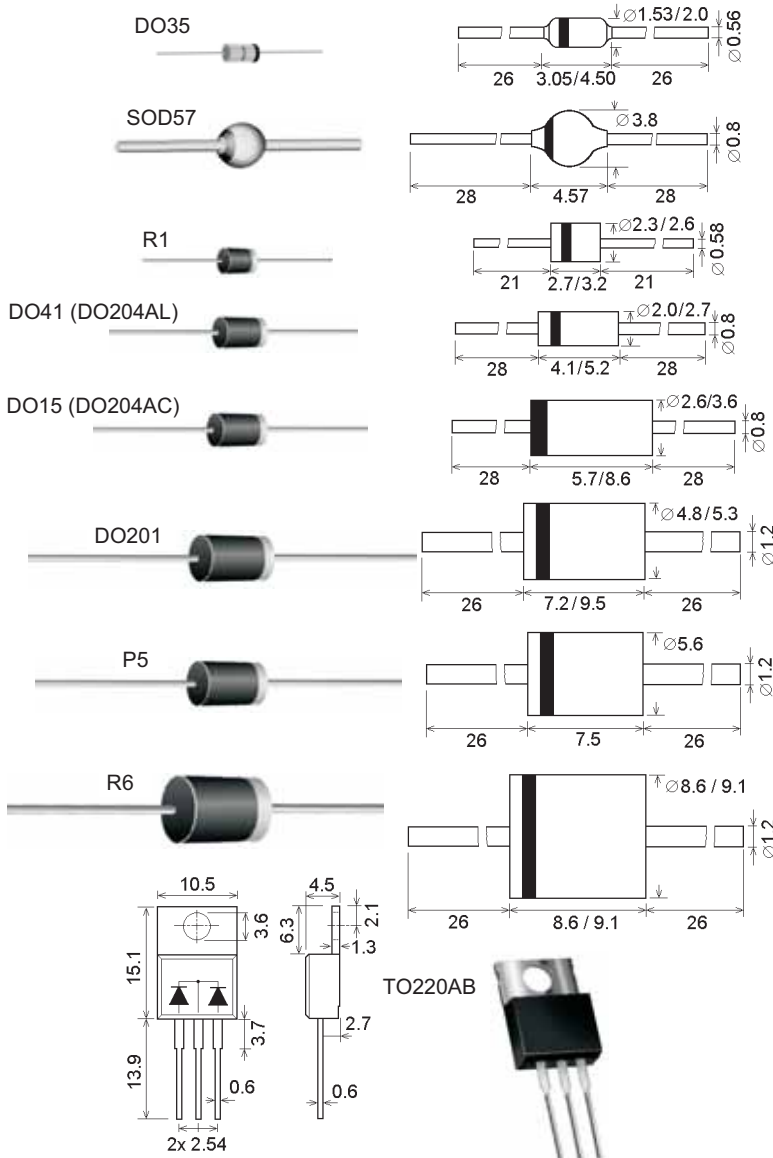

Diody rychlé do 1A

objednávací název	I _f max(A)	U _r max(V)	trr(ns)	pouzdro
1N914	0.10	80	4	DO 35
1N 4151	0.215	75	2	DO 35
■ 1N 4148	0.215	100	4	DO 35
■ 1N 4448	0.215	100	4	DO 35
■ BAV 20	0.25	200	50	DO 35
■ BAV 21	0.25	250	50	DO 35
RGP02-16E	0.5	1600	300	DO 41
RGP02-20E	0.5	2000	300	DO 41
■ BYV 26C	0.65	600	30	SOD 57
GP08A	0.8	50	2000	DO 41
GP08B	0.8	100	2000	DO 41
GP08D	0.8	200	2000	DO 41
GP08G	0.8	400	2000	DO 41
GP08J	0.8	600	2000	DO 41
HER 101	1	50	50	DO 41
HER 102	1	100	50	DO 41
HER 104	1	300	50	DO 41
HER 105	1	400	50	DO 41
HER 106	1	600	75	DO 41
HER 107	1	800	75	DO 41
HER 108	1	1000	75	DO 41
GUF 10A	1	50	50	DO 41
GUF 10B	1	100	50	DO 41
GUF 10D	1	200	50	DO 41
GUF 10F	1	300	50	DO 41
GUF 10G	1	400	50	DO 41
GUF 10J	1	600	75	DO 41
GUF 10K	1	800	75	DO 41
GUF 10M	1	1000	75	DO 41
RGP 10A	1	50	150	DO 41
RGP 10B	1	100	150	DO 41
RGP 10D	1	200	150	DO 41
RGP 10G	1	400	150	DO 41
RGP 10J	1	600	250	DO 41
RGP 10K	1	800	500	DO 41
RGP 10M	1	1000	500	DO 41
1N 4933GP	1	50	200	DO 41
1N 4934GP	1	100	200	DO 41
1N 4935GP	1	200	200	DO 41
1N 4936GP	1	400	200	DO 41
1N 4937GP	1	600	200	DO 41
GP 10A	1	50	2000	DO 41
GP 10B	1	100	2000	DO 41
GP 10D	1	200	2000	DO 41
GP 10G	1	400	2000	DO 41
GP 10J	1	600	2000	DO 41
GP 10K	1	800	2000	DO 41
GP 10M	1	1000	2000	DO 41
UGPZ10D	1	200	35	DO 41
UGPZ10G	1	400	35	DO 41
EGPZ 10D	1	200	50	DO 41
EGPZ 10G	1	400	50	DO 41
EGPZ 10K	1	800	75	DO 41
1N 4942GP	1	200	150	DO 41
1N 4944GP	1	400	150	DO 41
1N 4946GP	1	600	250	DO 41
1N 4947GP	1	800	250	DO 41
1N 4948GP	1	1000	500	DO 41
RGPZ 10G	1	400	150	DO 41
RGPZ 10J	1	600	250	DO 41
RGPZ 10M	1	1000	500	DO 41
■ 1N 4936	1	400	200	DO 41
1N 4937	1	600	200	DO 41
SF 17	1	500	50	DO 41
SF 18	1	600	50	DO 41
■ UF 4007	1	1000	75	DO 41
BA 158	1	600	300	DO 41
■ BA 159	1	1000	500	DO 41
FR 110	1	1000	500	DO 41
1N 4007GP	1	1000	2000	DO 41
GPZ 10G	1	400	2000	DO 41
GPZ 10M	1	1000	2000	DO 41
GPZ 10Q	1	1200	2000	DO 41



Diody rychlé výkonové do 2 A

objednávací název	I _f max(A)	U _r max(V)	t _{rr} (ns)	pouzdro
■ BYW 95C	1.25	600	250	SOD 64
■ BYV 27/100	1.3	100	25	SOD 57
■ BYV 27/200	1.3	200	25	SOD 57
RGP 15A	1.5	50	150	DO 15
RGP 15B	1.5	100	150	DO 15
RGP 15D	1.5	200	150	DO 15
RGP 15G	1.5	400	150	DO 15
RGP 15J	1.5	600	250	DO 15
RGP 15K	1.5	800	500	DO 15
RGP 15M	1.5	1000	500	DO 15
FR 1510	1.5	1000	500	DO 15
GP 15A	1.5	50	2000	DO 15
GP 15B	1.5	100	2000	DO 15
GP 15D	1.5	200	2000	DO 15
GP 15G	1.5	400	2000	DO 15
GP 15J	1.5	600	2000	DO 15
GP 15K	1.5	800	2000	DO 15
GP 15M	1.5	1000	2000	DO 15
GPZ 15A	1.5	50	2000	DO 41
1N 5391GP	1.5	50	2000	DO 15
1N 5392GP	1.5	100	2000	DO 15
1N 5393GP	1.5	200	2000	DO 15
1N 5395GP	1.5	400	2000	DO 15
1N 5396GP	1.5	500	2000	DO 15
1N 5397GP	1.5	600	2000	DO 15
1N 5398GP	1.5	800	2000	DO 15
1N 5399GP	1.5	1000	2000	DO 15
GPZ 15B	1.5	100	2000	DO 41
GPZ 15D	1.5	200	2000	DO 41
GPZ 15G	1.5	400	2000	DO 41
GPZ 15J	1.5	600	2000	DO 41
GPZ 15K	1.5	800	2000	DO 41
GPZ 15M	1.5	1000	2000	DO 41
UGPZ20G	2	400	35	DO 15
■ SF 24	2	200	35	DO 15
EGPZ 20G	2	400	50	DO 15
EGPZ 20M	2	1000	75	DO 15
GUF 20A	2	50	50	DO 15
GUF 20B	2	100	50	DO 15
GUF 20D	2	200	50	DO 15
GUF 20F	2	300	50	DO 15
GUF 20G	2	400	50	DO 15
GUF 20J	2	600	75	DO 15
RGP 20A	2	50	150	DO 15
RGP 20B	2	100	150	DO 15
RGP 20D	2	200	150	DO 15
RGP 20G	2	400	150	DO 15
RGP 20J	2	600	250	DO 15
RGPZ 20G	2	400	150	DO 15
RGPZ 20M	2	1000	500	DO 15
■ BYW 36	2	600	200	SOD 57
■ BY 299	2	800	500	DO 201
FR 210	2	1000	500	DO 15
GP 20A	2	50	2500	DO 15
GP 20B	2	100	2500	DO 15
GP 20D	2	200	2500	DO 15
GP 20G	2	400	2500	DO 15
GP 20J	2	600	2500	DO 15
GPZ 20G	2	400	2500	DO 15
GPZ 20M	2	1000	2500	DO 15

Diody rychlé výkonové do 6 A

objednávací název	I _f max(A)	U _r max(V)	t _{rr} (ns)	pouzdro
SF 31	3	50	35	DO 27A
SF 32	3	100	35	DO 27A
SF 34	3	200	35	DO 27A
SF 35	3	300	50	DO 27A
HER 301	3	50	50	DO 27A
HER 305	3	400	50	DO 27A
HER 306	3	600	75	DO 27A
HER 307	3	800	75	DO 27A
HER 308	3	1000	75	DO 27A
GUF 30B	3	100	50	DO 201
GUF 30D	3	200	50	DO 201
GUF 30F	3	300	50	DO 201
GUF 30G	3	400	50	DO 201
GUF 30J	3	600	75	DO 201
GUF 30K	3	800	75	DO 201
GUF 30M	3	1000	75	DO 201
UGPZ30F	3	300	35	DO 201
UGPZ30G	3	400	35	DO 201
EGPZ 30G	3	400	50	DO 201
EGPZ 30M	3	1000	75	DO 201
■ UF 5408	3	1000	75	DO 201
RGP 30B	3	100	150	DO 201
RGP 30D	3	200	150	DO 201
RGP 30G	3	400	150	DO 201
RGP 30J	3	600	250	DO 201
RGP 30K	3	800	500	DO 201
RGP 30M	3	1000	500	DO 201
RGPZ 30G	3	400	150	DO 201
RGPZ 30M	3	1000	500	DO 201
■ FR 34	3	400	150	DO 201
FR 36	3	600	250	DO 201
FR 310	3	1000	500	DO 201
■ BY 399	3	800	500	DO 201
GP 30A	3	50	3000	DO 201
GP 30B	3	100	3000	DO 201
GP 30D	3	200	3000	DO 201
GP 30G	3	400	3000	DO 201
GP 30J	3	600	3000	DO 201
GP 30K	3	800	3000	DO 201
GP 30M	3	1000	3000	DO 201
GPZ 30G	3	400	3000	DO 201
GPZ 30M	3	1000	3000	DO 201
■ MUR 460	4	600	75	DO 201
SF 61	6	50	35	DO 27A
SF 62	6	100	35	DO 27A
SF 63	6	150	35	DO 27A
SF 64	6	200	75	DO 27A
SF 66	6	400	75	DO 27A
FR 610	6	1000	500	R 6

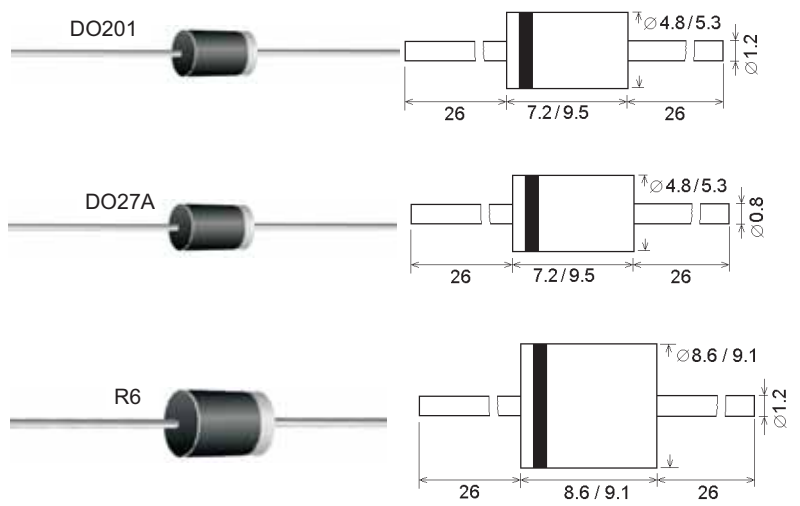
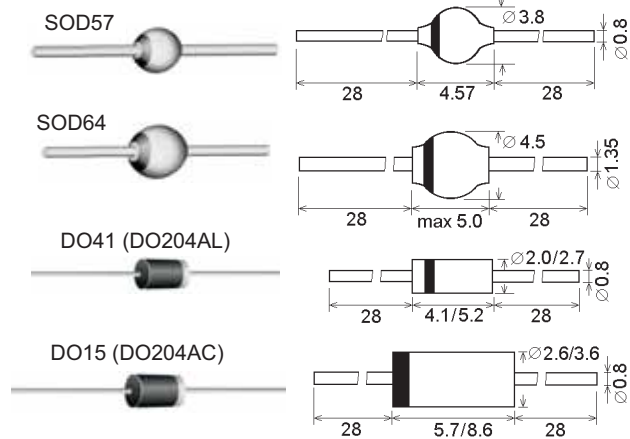

■ součástka se doplňuje na sklad

součástka na skladě, výprodej

Dodací podmínky neoznačených součástek sdělíme na poptávku

Diody rychlé výkonové do 16 A

objednávací název	I _f max(A)	U _r max(V)	t _{rr} (ns)	pouzdro
■ BYW 29E/150	8	150	25	TO 220AC
■ BYW 80/200	8	200	35	TO 220AC
■ MUR 860	8	600	100	TO 220AC
UF 08-01	8	100	35	TO 220AC
UF 08-02	8	200	60	TO 220AC
UF 08-04	8	400	60	TO 220AC
UF 08-06	8	600	60	TO 220AC
UF 08-08	8	800	100	TO 220AC
UF 08-09	8	900	100	TO 220AC
UF 08-10	8	1000	100	TO 220AC
FR 82	8	200	150	TO 220AC
FR 86	8	600	250	TO 220AC
FR 810	8	1000	500	TO 220AC
■ BYT 12P/1000	12	1000	65	TO 220AC
■ BYV 79E/200	14	200	30	TO 220AC
■ MUR 1560	15	600	60	TO 220AC

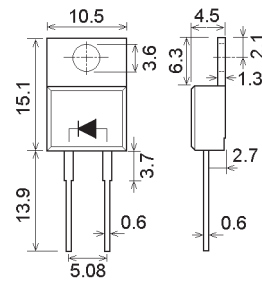

Diody rychlé výkonové 2x8 A

objednávací název	I _f max(A)	U _r max(V)	t _{rr} (ns)	pouzdro
■ MUR 1620 CTR	2x8	200	35	TO 220ABR
UF16C40A	2x8	400	50	TO 220ABR
UF16C50A	2x8	500	50	TO 220ABR
UF16C60A	2x8	600	50	TO 220ABR
■ MUR 1620 CT	2x8	200	35	TO 220AB
UF16C40C	2x8	400	50	TO 220AB
UF16C50C	2x8	500	50	TO 220AB
UF16C60C	2x8	600	50	TO 220AB
UF16C20D	2x8	200	35	TO 220ABD
UF16C40D	2x8	400	50	TO 220ABD
UF16C50D	2x8	500	50	TO 220ABD
UF16C60D	2x8	600	50	TO 220ABD
■ BYV 32/200	2x10	200	25	TO 220AB

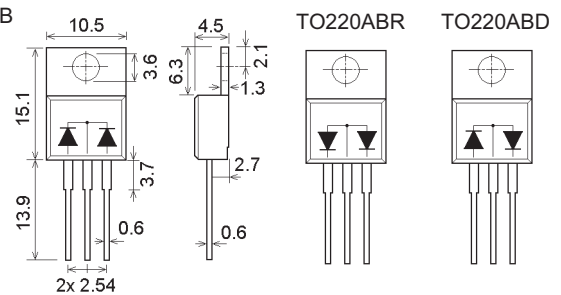

Diody rychlé výkonové 2x15 A

objednávací název	I _f max(A)	U _r max(V)	t _{rr} (ns)	pouzdro
UF30C05A	2x15	50	35	TO 3PR
UF30C10A	2x15	100	35	TO 3PR
UF30C20A	2x15	200	35	TO 3PR
UF30C40A	2x15	400	50	TO 3PR
UF30C60A	2x15	600	50	TO 3PR
UF30C05C	2x15	50	35	TO 3P
UF30C10C	2x15	100	35	TO 3P
UF30C20C	2x15	200	35	TO 3P
UF30C40C	2x15	400	50	TO 3P
UF30C60C	2x15	600	50	TO 3P
UF30C05D	2x15	50	35	TO 3PD
UF30C10D	2x15	100	35	TO 3PD
UF30C20D	2x15	200	35	TO 3PD
UF30C40D	2x15	400	50	TO 3PD

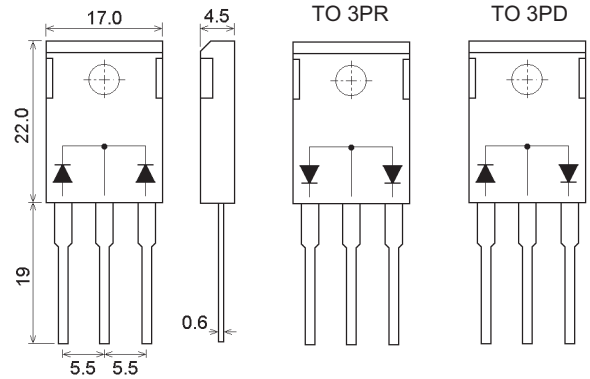
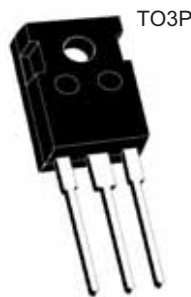

Diody rychlé výkonové do 100 A

objednávací název	I _f max(A)	U _r max(V)	t _{rr} (ns)	pouzdro
■ BYV 52/200	2x30	200	80	SOT 93
■ BYV 54V/200	2x50	200	80	ISOTOP

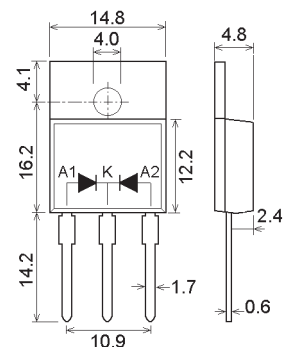
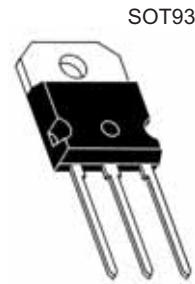
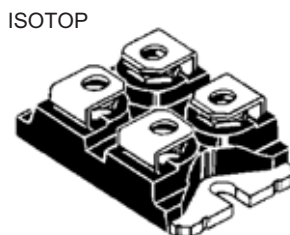
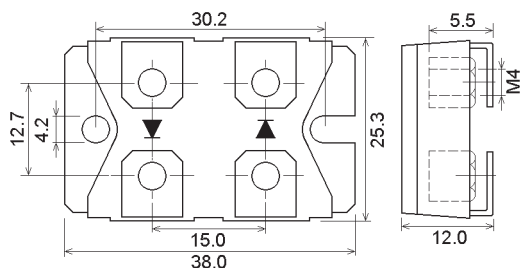

Diody na vysoké napětí

objednávací název	I _f max(A)	U _r max(V)	t _{rr} (ns)	pouzdro
GP 02-25	0.2	2500	2000	DO 41
GP 02-30	0.2	3000	2000	DO 41
GP 02-35	0.2	3500	2000	DO 41
GP 02-40	0.2	4000	2000	DO 15
GP 02-50	0.2	5000	2000	DO 15
GP 02-60	0.2	6000	2000	DO 15
FR 02-25	0.2	2500	500	DO 41
FR 02-30	0.2	3000	500	DO 41
FR 02-35	0.2	3500	500	DO 15
FR 02-40	0.2	4000	500	DO 15
FR 02-45	0.2	4500	500	DO 15
FR 02-50	0.2	5000	500	DO 15
FR 02-60	0.2	6000	500	DO 15
GP 05-10	0.5	1000	2000	DO 41
GP 05-15	0.5	1500	2000	DO 41
GP 05-18	0.5	1800	2000	DO 41
GP 05-20	0.5	2000	2000	DO 41
FR 05-10	0.5	1000	500	DO 41
FR 05-15	0.5	1500	500	DO 41
FR 05-16	0.5	1600	500	DO 41
FR 05-18	0.5	1800	500	DO 41
FR 05-20	0.5	2000	500	DO 41
HV 03-08	0.35	8000		HV 05
HV 03-09	0.35	9000		HV 05
HV 03-10	0.35	10 000		HV 05
HV 03-12	0.35	12 000		HV 05
HV 03-14	0.35	14 000		HV 05
HV 03-15	0.35	15 000		HV 05
HV 05-06	0.55	6000		HV 05
HV 05-08	0.55	8000		HV 05
HV 05-10	0.55	10 000		HV 05
HV 05-12	0.55	12 000		HV 05
HV 05-14	0.55	14 000		HV 05
HV 05-15	0.55	15 000		HV 05
HV 07-08	0.75	8000		HV 07
HV 07-10	0.75	10 000		HV 07
HV 07-12	0.75	12 000		HV 07
HV 07-15	0.75	15 000		HV 07
HV 07-16	0.75	16 000		HV 07
FV 05M-12	1	12 000	18 ms	FV 05
FV 05M-16	1	16 000	24 ms	FV 05

Diody pro automobily

objednávací název	I _f max(A)	U _r max(V)	t _{rr} (ns)	pouzdro
FR 2502	25	200	3000	Button
FR 2502S	25	200	3000	Button S
FR 2502L	25	200	3000	Button L
FR 2502 SMD	25	200	3000	Button SMD
FR 2504	25	400	3000	Button
FR 2504S	25	400	3000	Button S
FR 2506	25	600	3000	Button
FR 2508	25	800	3000	Button
FR 2508S	25	800	3000	Button S
FR 2510	25	1000	3000	Button
FR 2510S	25	1000	3000	Button S
FR 2510SMD	25	1000	3000	Button SMD
VFR 2510	25	1000	200	Button
FR 3501	35	100	3000	Button
FR 3502	35	200	3000	Button
FR 3503	35	300	3000	Button
FR 3506	35	600	3000	Button
FR 3508	35	800	3000	Button
FR 3510	35	1000	3000	Button
FR 5001	50	100	3000	Button
FR 5001S	50	100	3000	Button S
FR 5003	50	300	3000	Button
FR 5003S	50	300	3000	Button S
FR 5004	50	400	3000	Button
FR 5004S	50	400	3000	Button S
FR 7004	70	400	3000	Button2
PFR 2510	25	1000	3000	Press Fit
PFR 3510	35	1000	3000	Press Fit
PFR 5002	50	200	3000	Press Fit
PFR 5002A	50	200	3000	Press Fit A

Diody pro přepět'ovou ochranu

objednávací název	I _f max(A)	U _r max(V)	t _{rr} (ns)	pouzdro
FR 2523	25	16		Button
FR 2528	25	20		Button
FR 2535	25	24		Button
FR 2538	25	27		Button
FR 2543	25	33		Button
FR 3228 SMD	32	20		Button SMD
FR 3543	35	33		Button
FR 4043	40	33		Button
FR 5028	50	20		Button
FR 7028	70	20		Button2

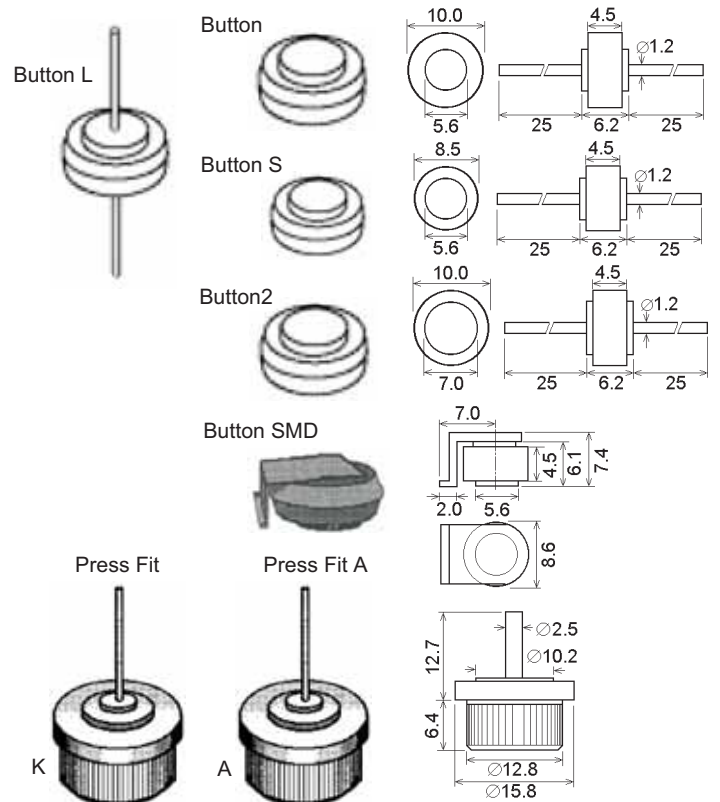
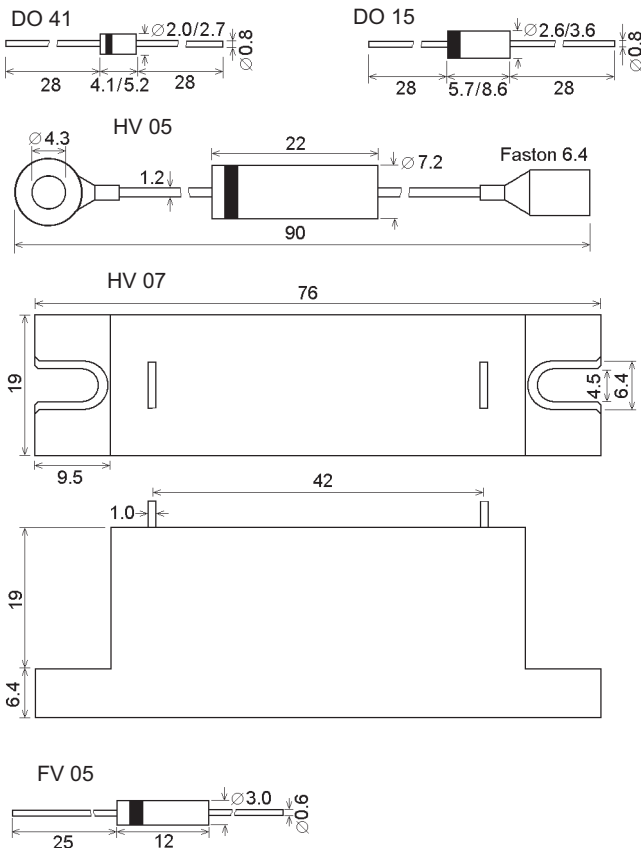

Diody Schottky

objednáací název	I _f max(A)	U _r max(V)	pouzdro
■ BAT 46	0.15	100	DO 35
■ BAT 42	0.20	30	DO 35
■ BAT 43	0.20	30	DO 35
■ BAT 85	0.20	30	DO 34
■ BAT 48	0.35	40	DO 35
SR 040	0.50	40	DO 41
■ BAT 49	0.50	80	DO 41
SR 130	1	30	DO 41
■ 1N 5818	1	30	DO 41
■ 1N 5819	1	40	DO 41
SR 140	1	40	DO 41
SR 160	1	60	DO 41
SR 180	1	80	DO 41

Diody Schottky výkonové

objednáací název	I _f max(A)	U _r max(V)	pouzdro
SR 230	2	30	DO 41
■ SB 260	2	60	DO 41
SR 290	2	90	DO 41
■ 1N 5822	3	40	DO 201
■ BYS26-45	3	45	P5
■ SR 350	3	50	DO 201
SR 360	3	60	DO 201
SR 520	5	20	DO 201
SR 530	5	30	DO 201
■ SR 540	5	40	DO 201
■ SR 560	5	60	DO 201
■ SB 5100	5	100	DO 201
FBR 745 (R)	7.5	45	TO 220AC
■ MBR 760	7.5	60	TO 220AC
FBR 845 (R)	8	45	TO 220AC
■ PBYR 1045	10	45	TO 220AC
FBR 1045 (R)	10	45	TO 220AC
FBR 1060 (R)	10	60	TO 220AC
FBR 1090 (R)	10	90	TO 220AC
■ MBR 1545CT	2x7.5	45	TO 220AB
SR 1035C (A)	2x10	35	TO 220AB
SR 1045C (A)	2x10	45	TO 220AB
FBR 1660	16	60	TO 220AC
■ MBR 2535CTL	2x12.5	35	TO 220AB
FBR 2545CTL	2x12.5	45	TO 220AB
SR 1645C (A)	2x16	45	TO 220AB
FBR 2060C (A)	2x20	60	TO 220AB
FBR 2090C (A)	2x20	90	TO 220AB
■ MBR2535CTL	2x25	35	TO 220AB
FBR 2545C (A)	2x25	45	TO 220AB
FBR 2560C (A)	2x25	60	TO 220AB
FBR 3045C (A)	2x30	45	TO 3P
FBR 3060C (A)	2x30	60	TO 3P
FBR 3090C (A)	2x30	90	TO 3P
FBR 4040C (A)	2x40	40	TO 3P
FBR 4060C (A)	2x40	60	TO 3P
FBR 5060C (A)	2x50	60	TO 3P
FBR 6045C (A)	2x60	45	TO 3P
FBR 6060C (A)	2x60	60	TO 3P

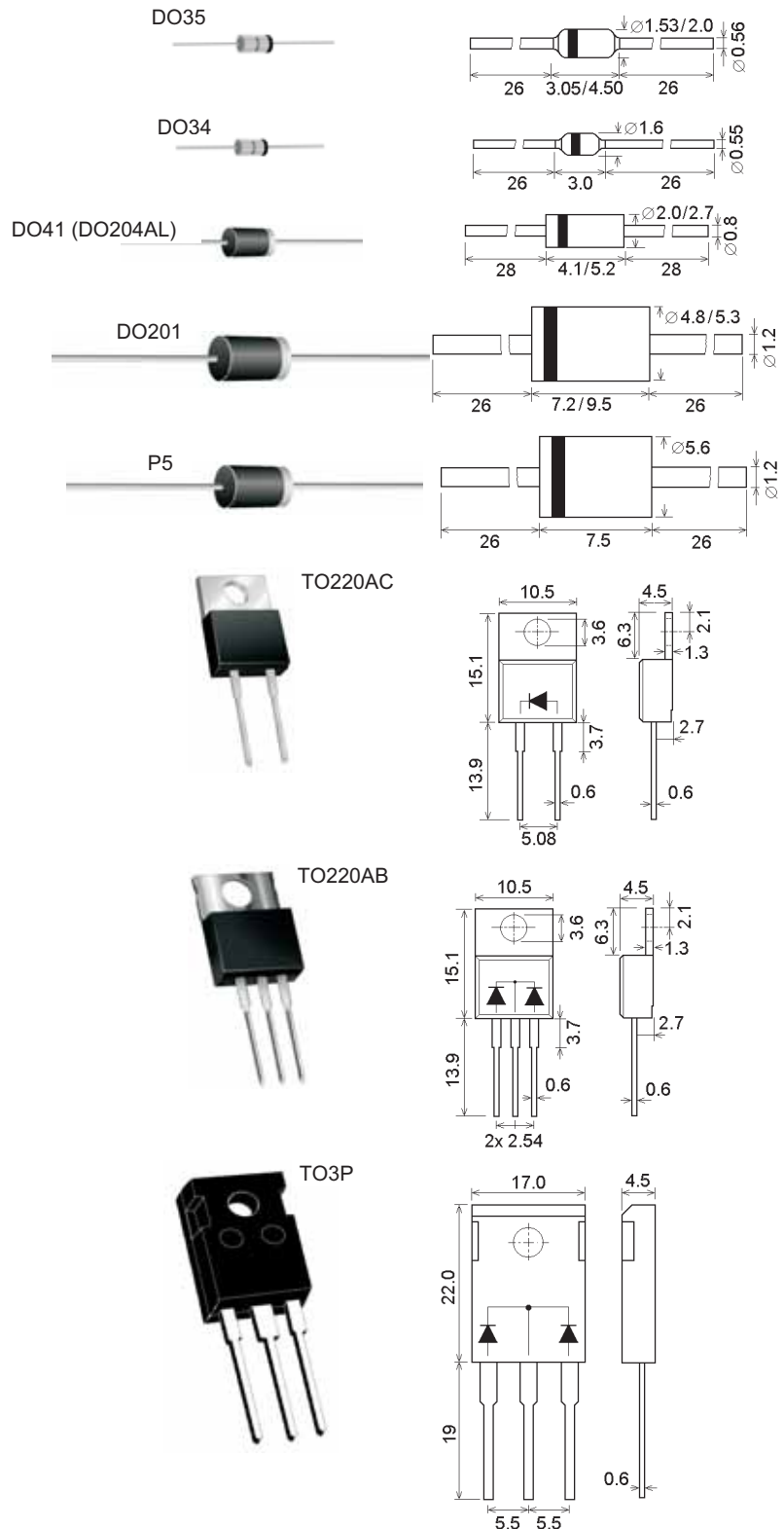

Poznámka:

1. Typy s příponou R mají opačnou polaritu vývodů než typy bez přípony.
2. Typy s příponou A mají vývody se společnou anodou
3. Typy s příponou C mají vývody se společnou katodou